

PRODUCT INFORMATION PACKET

Model No: 056S17D5701

Catalog No: B600

Fan and Blower Motor, 0.50 & 0.17 HP, 1 Ph, 60 Hz, 115 & 115 V, 1800 & 1800 RPM, 56 Frame, DP



Regal and Marathon are trademarks of Regal Rexnord Corporation or one of its affiliated companies.

©2024 Regal Rexnord Corporation, All Rights Reserved. MC017097E

Nameplate Specifications

Phase	1	Output HP	0.50 & 0.17 Hp
Output KW	0.37 & 0.13 kW	Voltage	115 & 115 V
Speed	1725 & 1140 rpm	Service Factor	1.25 & 1.25
Frame	56	Enclosure	Drip Proof
Thermal Protection	Automatic	Efficiency	61 & 41.4 %
Ambient Temperature	40 °C	Frequency	60 Hz
Current	8.1 & 4.5 A	Power Factor	68.3
Duty	Continuous	Insulation Class	B
Design Code	2VT	KVA Code	M
Drive End Bearing Size	6203	Opp Drive End Bearing Size	6203
UL	Recognized	CSA	Y
CE	N	IP Code	22
Number of Speeds	2		

Technical Specifications

Electrical Type	Split Phase	Starting Method	Across The Line
Poles	4//6	Rotation	Selective Counterclockwise
Mounting	Resilient Base - Extended Studs	Motor Orientation	Horizontal
Drive End Bearing	Ball	Opp Drive End Bearing	Ball
Frame Material	Rolled Steel	Shaft Type	T
Overall Length	11.85 in	Shaft Diameter	0.625 in
Shaft Extension	1.88 in	Assembly/Box Mounting	F1 Only
Connection Drawing	102014-25	Outline Drawing	A-100302-756

This is an uncontrolled document once printed or downloaded and is subject to change without notice. Date Created:05/19/2024

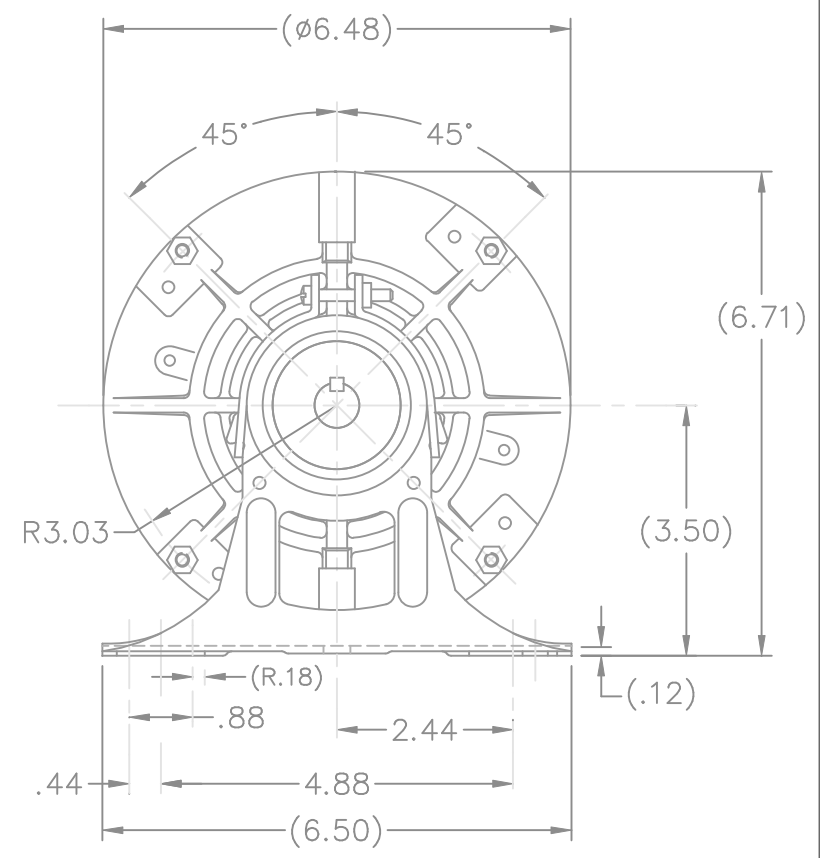
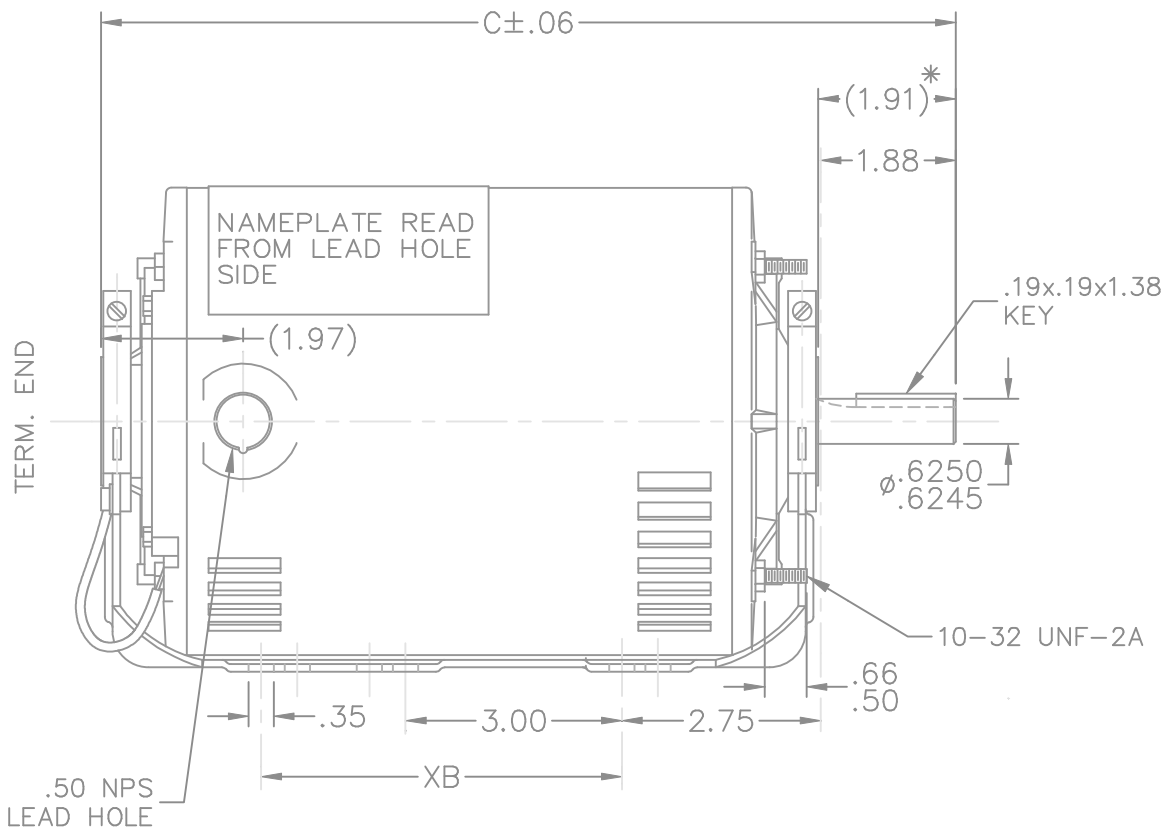

* DIMENSION IS FROM RESILIENT RING END CAP TO END OF SHAFT

NOTE:
1. MOTOR MUST BE ROTATED TO .75" STRIP SOCKET CLEARANCE FOR GROUND SCREW, MAXIMUM (10 DEGREES).

DASH	FRAME	C	XB	DASH	FRAME	C	XB
606	56-60	10.35	0	806	56-80	12.35	5.00
656	"-65	10.85	0	856	"-85	12.85	5.00
706	"-70	11.35	0	906	"-90	13.35	5.00
756	"-75	11.85	5.00	956	"-95	13.85	5.00

				TOLERANCES UNLESS SPECIFIED		DRAWN ML 04-01-1992			
				DEC.	INCHES		CHK GP 04-01-1992		
6	REDRAWN IN AUTOCAD	TAT 08-03-2004	ML	.X	±.1	APPD GK 04-01-1992			
5	ADDED NOTE CN 24378	PGK 06-11-1997		.XX	±.03	SCALE 3=8			
4	REV. STUD BOLT LENGTH - WAS .66/.54 CN 20775-571	DT 10-06-1995		.XXX	±.005	REF			
3	REDRAWN-REMOVED 2 VENTS TERM END CN 14111	ML 04-02-1992		.XXXX	±.0005	FMF			
NO.	REVISION	BY & DATE	CHK	ANG	±'30"	PREV			
THIS DRAWING IN DESIGN AND DETAIL IS OUR PROPERTY AND MUST NOT BE USED EXCEPT IN CONNECTION WITH OUR WORK ALL RIGHTS OF DESIGN AND INVENTION ARE RESERVED THIS IS AN ELECTRONICALLY GENERATED DOCUMENT - DO NOT SCALE THIS PRINT				RFP	CAD FILE 100302	SIZE A	DRAWING NO. 100302	PAGE OF	REV. 6
				DIST WP					



TITLE OUTLINE
56 FR.-BB-DR.PR.-RESIL. BASE-3Ø

MAT'L.
FINISH

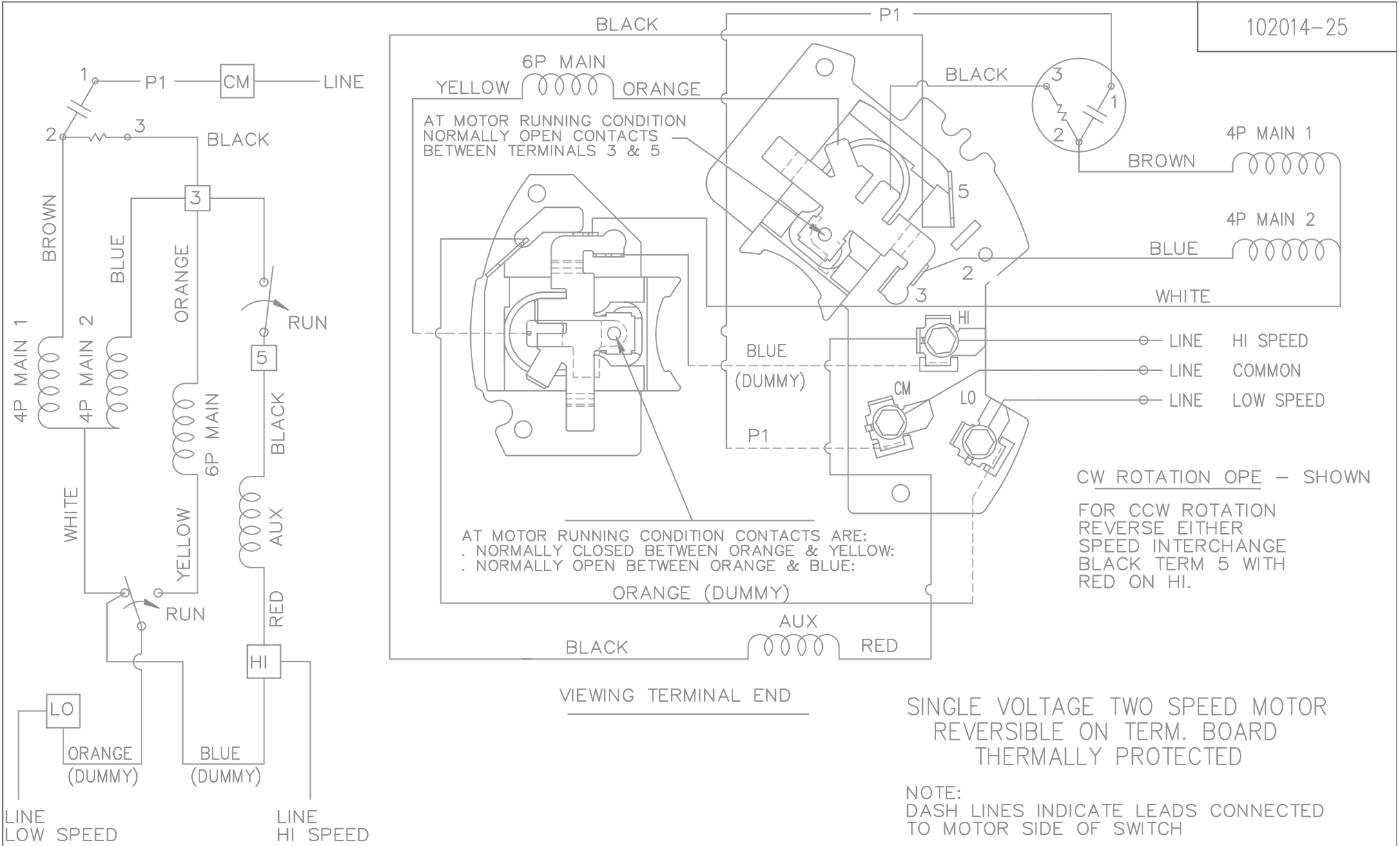

5	UPDATED ROTATION NOTE CN 24300-453	DRS 09-23-2002	ML	TOLERANCES UNLESS SPECIFIED			DRAWN ML 09-07-1988			
4	REMOVED 1 RED LEAD, ADDED ORANGE DUMMY			DEC.	INCHES		CHK GK 09-07-1988			
	REV. REVERSING INSTRUCTIONS 3702086	ML 05-31-1990		.X	± -		APPD CHE 09-08-1988			
3	ONE RED LEAD WAS ORANGE DUMMY CN 10880	GK 05-10-1989		.XX	± -		SCALE 1=1			
2	RUNNING NOTE BETWEEN ORANGE & BLUE WAS BETWEEN ORANGE & BLACK CN 10495	BW 01-24-1989		.XXX	± -		REF			
				.XXXX	± -	MAT'L.	FMF			
NO.	REVISION	BY & DATE	CHK	ANG	± -	FINISH	PREV			
THIS DRAWING IN DESIGN AND DETAIL IS OUR PROPERTY AND MUST NOT BE USED EXCEPT IN CONNECTION WITH OUR WORK ALL RIGHTS OF DESIGN AND INVENTION ARE RESERVED THIS IS AN ELECTRONICALLY GENERATED DOCUMENT - DO NOT SCALE THIS PRINT				RFP	CAD FILE 102014-25		SIZE A	DRAWING NO. 102014-25	PAGE OF	REV. 5
				DIST WP						